

Panel Mount, Rotary Thumbwheel Reset

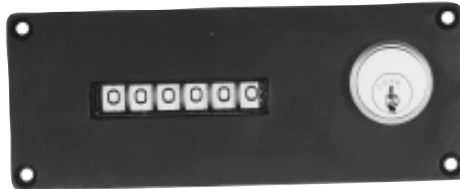

Panel Mount, Lock and Key Reset



Base Mount,
Knob Reset

*A rugged workhorse . . .
with proven extra reliability
for demanding industrial
applications*

A popular 6-digit totalizer featuring heavy duty diecast construction that can really take the severe punishment found in so many industrial applications. Originally designed over 50 years ago, and periodically upgraded to use the latest improved materials, the Series 1205 is perhaps the most popular counter in the world, and sets the standard for rugged totalizing counters.

Available in base mount/knob reset, panel mount/rotary reset, and panel mount/lock & key reset models.

- Designed for industrial duty
- Corrosion and shock resistant
- Extremely stable over temperature and voltage
- Easy-to-view black on white characters
- Count speed to 1000 per minute
- Non-rectified design – precision AC coil
- Long service life in harsh environments
- Lock & key reset model protects counted totals

The Series 1205 is tough: Wide temperature variations don't upset its thermo-stable wheels and pinions. Severe voltage transients will not damage its direct AC coil, so external surge protection is not required. Duty cycles that result in continuous coil energization won't degrade its life or performance.

For LCD or LED display, see Series 7997 and 7995
For low voltage or DC operation, see Series 7443

SPECIFICATIONS

Count Speed: 1000 cpm, 30 ms minimum on-time and off-time

Voltage: 115, 230 VAC models. Allowable variation is ± 10 volt

Power Consumption: 6 watts nominal

Number of Figures: 6

Size of Figures: 0.188 in. high by 0.156 in. wide

Reset: Manual rotary or lock and key. See models

Connections: 7"5 (190 mm), #22 AWG Leads from bottom

Construction: Wheels, pinions: plastic. Frame, covers: Zamak. Bobbin: nylon

Net Weight: Base Mount: 14 oz. (397 g); Panel Mount: 1 lb., 4 oz. (567 g);

Lock and Key Reset: 1 lb., 8 oz. (680 g)

Model No.	Description
0120506-010	Base mount, knob reset, 115 VAC
0120506-011	Base mount, knob reset, 230 VAC
0120506-100	Panel mount, rotary thumbwheel reset, 115 VAC
0120506-397	Panel mount, lock and key reset, 115 VAC

Dimensions:

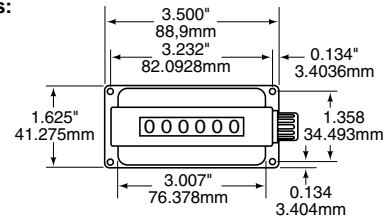

Panel Mount, Rotary Reset
Depth: 2.661"/67.6mm

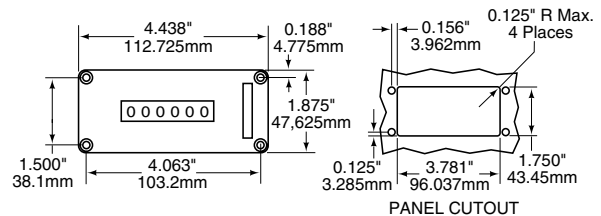

Panel Mount, Lock & Key Reset
Depth: 2.661"/67.6mm

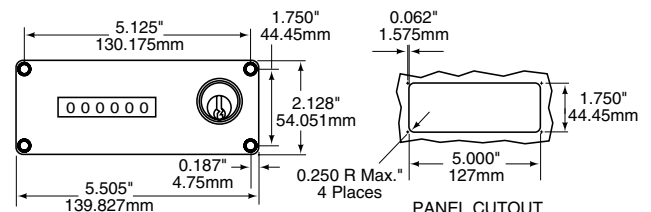

Typical Applications:

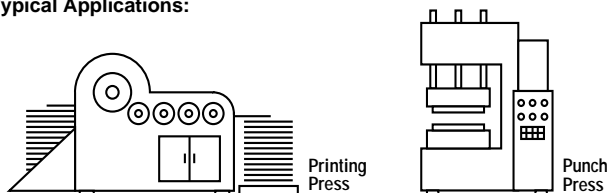

Ideal for punch presses, printing equipment, shears, and other heavy industrial machinery.